

Heimdal Security Installation Guide



1. Download the appropriate Windows install file from the "[Remote Work](#)" website.
2. Double click the installer
3. If you get the popup below, first select **"more info"** then choose **"Run anyway"**



4. Once the install has started, scroll down to the bottom of the terms, you can now select **"I agree"**

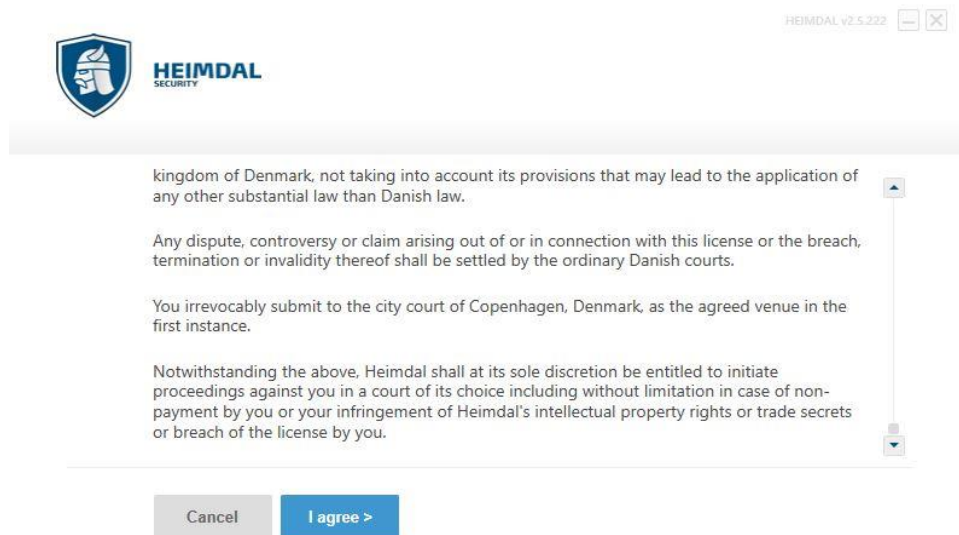

5. You are taken to the Welcome page, click **Next**.

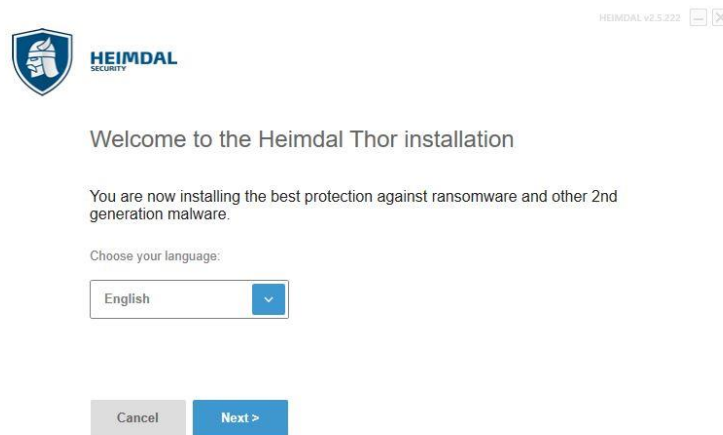

6. Click Next. *Do not check any boxes.*

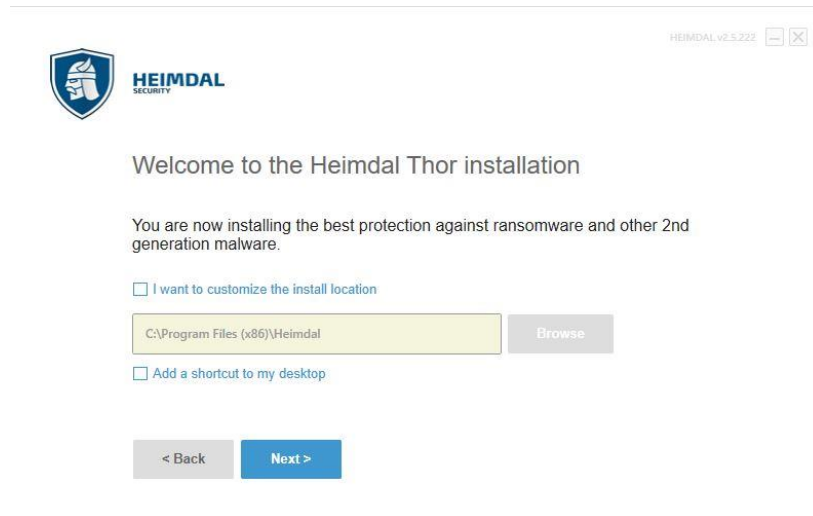

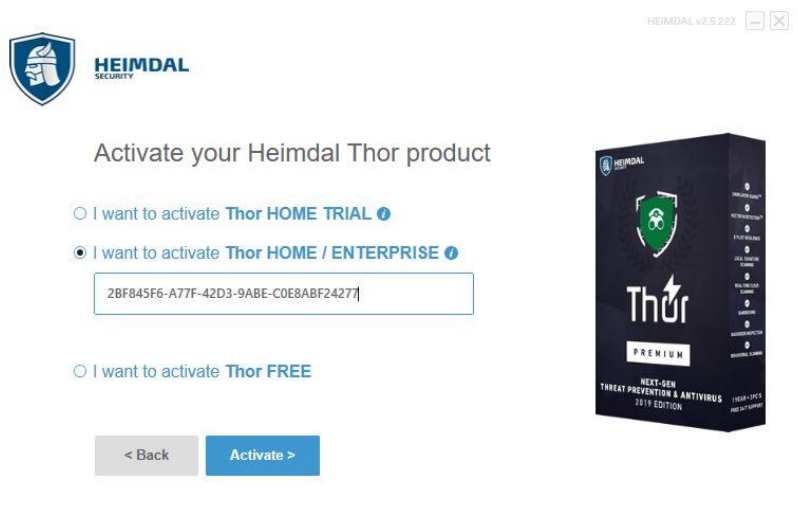

7. Select the second option **Thor Home/ Enterprise** and enter the following **key** and click **Activate**:

2BF845F6-A77F-42D3-9ABE-C0E8ABF24277

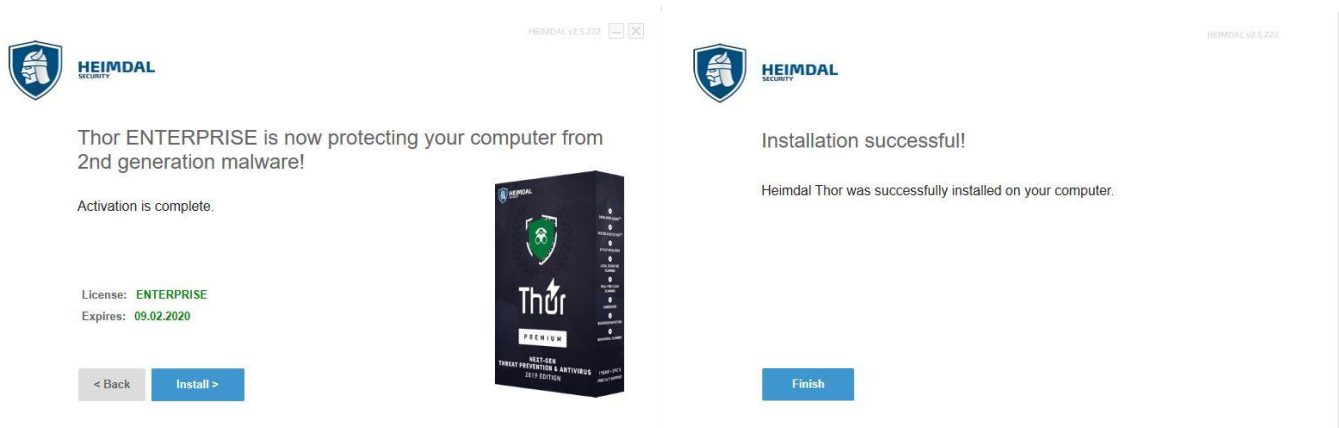

8. Click **Install** and then **Finish**.



9. Now, **Right click** on the “Windows”  icon on the bottom left of your screen and choose **System**.
10. Look for “Device Name” in the Device specifications section:

Device specifications

XPS 13 9350 Signature Edition

Device name SILT2545

Processor	Intel(R) Core(TM) i5-6200U CPU @ 2.30GHz 2.40 GHz
Installed RAM	8.00 GB (7.87 GB usable)
Device ID	D4B0897F-EFD0-4001-900F-E7F33FC4356C
Product ID	00330-80000-00000-AA120
System type	64-bit operating system, x64-based processor
Pen and touch	Touch support with 10 touch points

Rename this PC

11. Email this device name to remotework@edsisolutions.com from your EDSI/work e-mail account.
12. Finally, **reboot** your computer.